

ONE  
SKY PARK

FEATURED BY

**VERSACE**  
CERAMICS

IMAN  
DEVELOPERS



# Timeless Art, Shaping Skylines



IMAN  
DEVELOPERS

We craft your dreams into elegant waves of luxury.  
Every residence is a masterpiece soaring skyward.



# Building Legacies Since 2016

01 2016  
OXFORD VILLAS

02 2017  
OXFORD RESIDENCES

03 2019  
OXFORD RESIDENCES 2

04 2021  
OXFORD BOULEVARD

05 2022  
OXFORD 212

06 2022  
OXFORD TERRACES

07 2022  
OXFORD TERRACES 2

08 2022  
THE GROVE

09 2023  
OXFORD GARDENS

10 2023  
10 OXFORD

11 2023  
GARDENS 2

12 2024  
ONE PARK CENTRAL

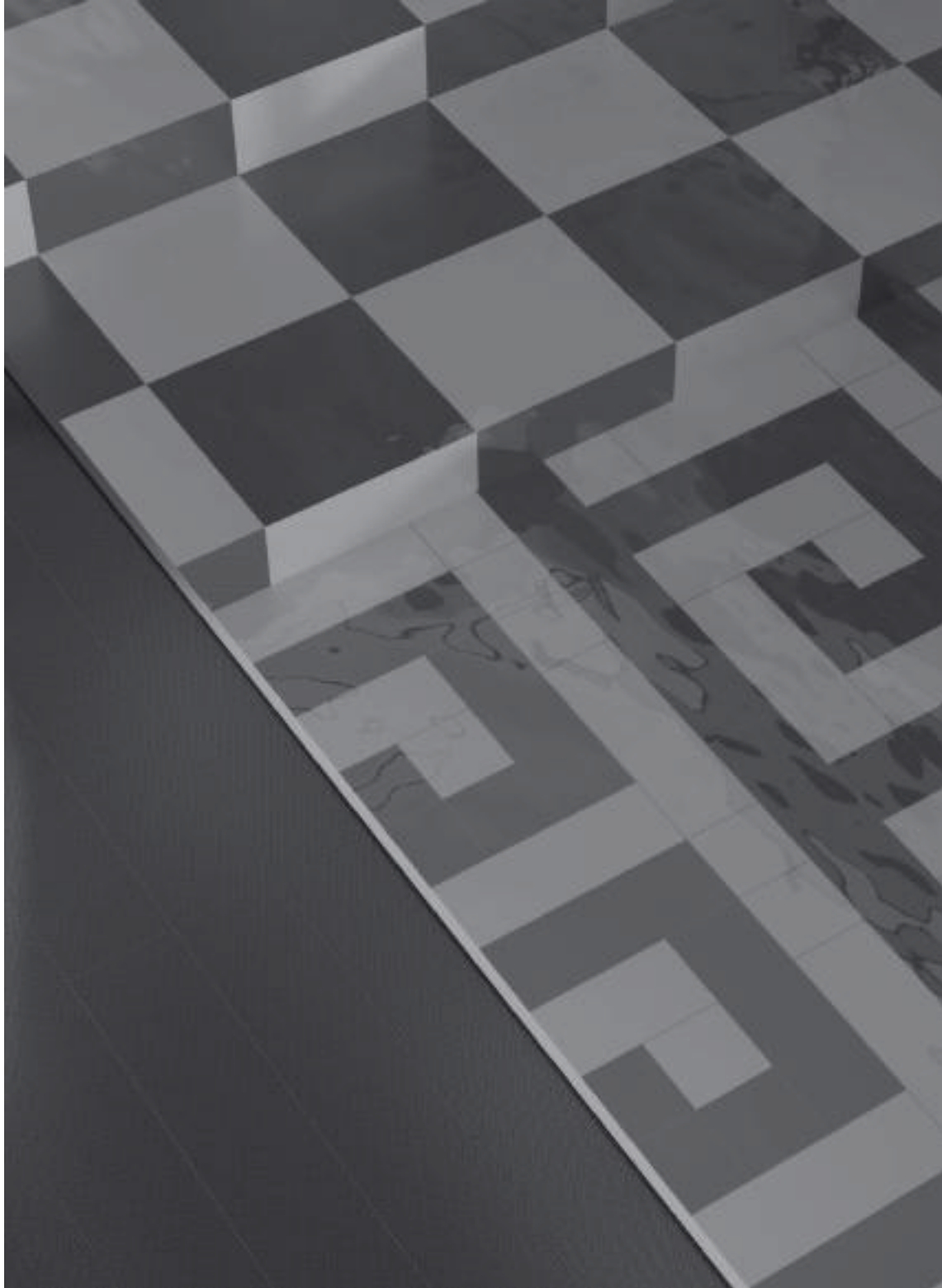

# The Allure Of Timeless Luxury

Versace is synonymous with high fashion and luxury, crafting an unmistakable identity through its fusion of opulence, bold design, and Italian craftsmanship. Known for setting global trends, the brand marries classical elegance with modern glamour, creating iconic pieces that resonate with a sense of timelessness. Every collection speaks to a legacy of sophistication, empowering those who embrace the Versace lifestyle with a distinct and unforgettable allure.



# VERSACE

## CERAMICS

Versace Ceramics extends the brand's iconic fashion philosophy into the realm of interior design, transforming living spaces into luxurious sanctuaries. Each tile embodies the brand's signature style, featuring intricate patterns, rich textures, and exquisite finishes that mirror the high fashion ethos of Versace. These ceramics are not just building materials but statements of art, offering homeowners a way to infuse their environments with the same bold elegance and attention to detail found on the runways.

# ONE SKY PARK

FEATURED BY  
**VERSACE**  
CERAMICS

## An Iconic Project

Iman Developers proudly announces One Sky Park featuring Versace Ceramics, seamlessly integrating the brand's iconic design and craftsmanship into our luxury residential project. This property merges Versace Ceramics' opulent aesthetics with our commitment to quality, redefining luxury living and offering an unparalleled experience of elegance and exclusivity. This fusion of visionary design and innovative real estate sets a new standard in luxury homes.

**IMAN**  
DEVELOPERS

# A New Icon In JVC

28min  
Al Maktoum  
Intl Airport

20min  
Palm  
Jumeirah

22min  
Expo  
City

22min  
Dubai  
Mall

36min  
Palm  
Jebel Ali

20min  
Mall of the  
Emirates

17min  
Bluewaters  
Island

27min  
Dubai Intl  
Airport (DXB)



ONE  
SKY PARK





# JVC: The Hub Of New Dubai

One Sky Park emerges as a landmark in Jumeirah Village Circle (JVC), proudly standing as the first branded skyscraper in this prestigious community. It introduces a new era of luxury, redefining the skyline and setting a benchmark for upscale living in JVC. Its prime location in new Dubai offers unparalleled access to key destinations like the Marina, Mall of the Emirates, and Miracle Garden, making it a beacon of elegance and a new icon in the heart of JVC.



# ONE SKY PARK

FEATURED BY  
**VERSACE**  
CERAMICS

## An Architectural Masterpiece

The towers of One Sky Park rise with a striking elegance, each boasting a gracefully curved facade that captures the essence of modern sophistication. The design's bold curves create a dynamic interplay of light and shadow, giving the towers an ever-changing visual appeal. Crowned by a stunning sky bridge, which forms a mesmerizing hollow between the towers, this architectural marvel offers a panoramic vista that redefines luxury. The bridge's sleek, open design not only enhances the towers' aesthetic allure but also creates a unique space for residents to connect with their surroundings and enjoy breathtaking views from above.





ONE SKY PARK BY IMAN DEVELOPERS



# Waves Of Opulence

The design concept of One Sky Park is a seamless blend of high fashion and architectural innovation, drawing inspiration from Iman's iconic style and the fluidity of waves. The building's elegant, wave-like facade captures the essence of motion, creating a dynamic yet harmonious structure that stands as a beacon of luxury living. Each curve and contour reflects Iman's commitment to bold design and timeless sophistication, elevating One Sky Park into a symbol of modern elegance and opulence in the heart of Dubai.



IMAN  
DEVELOPERS

ONE SKY PARK BY IMAN DEVELOPERS

37th Floor  
Penthouse (Tower B)

26th Floor  
Sky Deck Amenities (Tower A)

23rd / 24th Floor  
Penthouse (Duplex)

1st Floor  
Amenities Deck

Ground Floor  
Main Entrance Lobby,  
Lift Lobby, Retail shops, Showroom



One Sky Park featured by Versace Ceramics includes two towers that embody a seamless blend of luxury and functionality. Tower A provides exclusive amenities spread across multiple levels, while Tower B, the taller of the two, with 37 floors, is crowned with opulent penthouses. The building's design showcases a dynamic structural expression that elevates the living experience to new heights.

4 Podium Floors  
Lift Lobby, Parking

Basement  
Underground parking, Lift Lobby



ONE SKY PARK BY IMAN DEVELOPERS



# A Touchstone Of Fluid Design

One Sky Park embodies a commitment to a healthy lifestyle by creating an environment where well-being and luxury coexist harmoniously. The design and philosophy of the space emphasize balance, offering residents a retreat that nurtures both physical vitality and mental relaxation. From thoughtfully curated spaces to a focus on holistic wellness, One Sky Park ensures that every aspect of living supports a vibrant and balanced life.







Double Height Lobby



Double Height Lobby

ONE SKY PARK BY TIWAN DEVELOPERS

The background is a light-colored, marbled pattern with swirling, organic shapes in shades of white and light gray. A decorative Greek key border runs horizontally across the top and bottom of the image.

# Timeless Interiors As Unique As You Are

The interiors of One Sky Park radiate luxury and elegance, featured by Versace Ceramics that add a timeless touch of sophistication to every space.



ONE SKY PARK BY TIMAN DEVELOPERS

Living Area



Kitchen & Dining With Branded Appliances



Master Bedroom



Master Bathroom





Master Bathroom



# Signature Amenities For Refined Living

The luxury amenities at One Sky Park offer a holistic and upscale experience, designed to fulfill your most aspirational lifestyle desires.



Sky Deck 35m Infinity Pool

ONE SKY PARK BY IWAN DEVELOPERS



Sky Deck Pool & Zen Zone

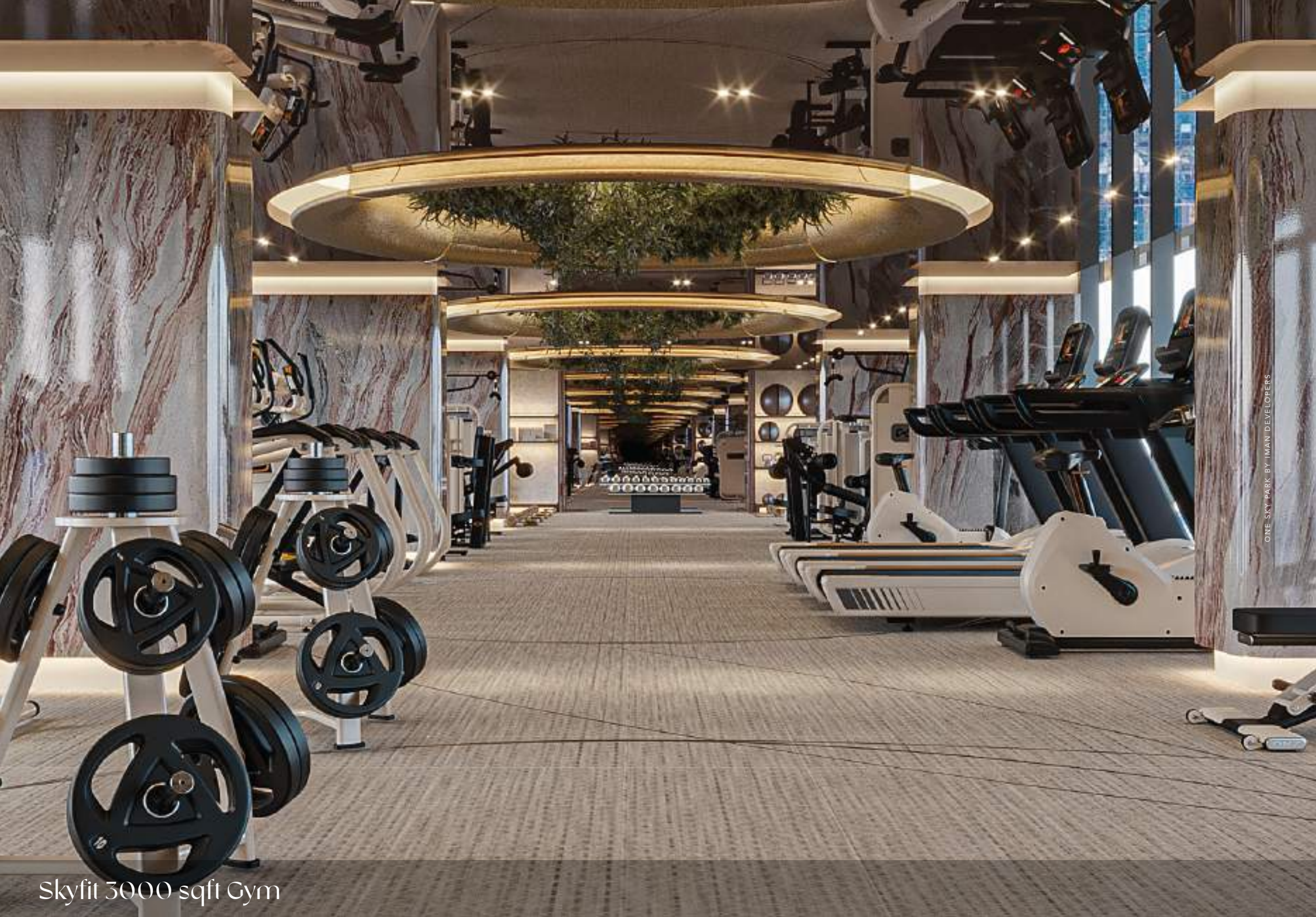

ONE SKY PARK BY IMAN DEVELOPERS

Skyfit 3000 sqft Gym



Games Zone & Multipurpose Lounge



Indoor Kid's Play Area



ONE SKY PARK BY IMAN DEVELOPERS

Virtual Reality Golf

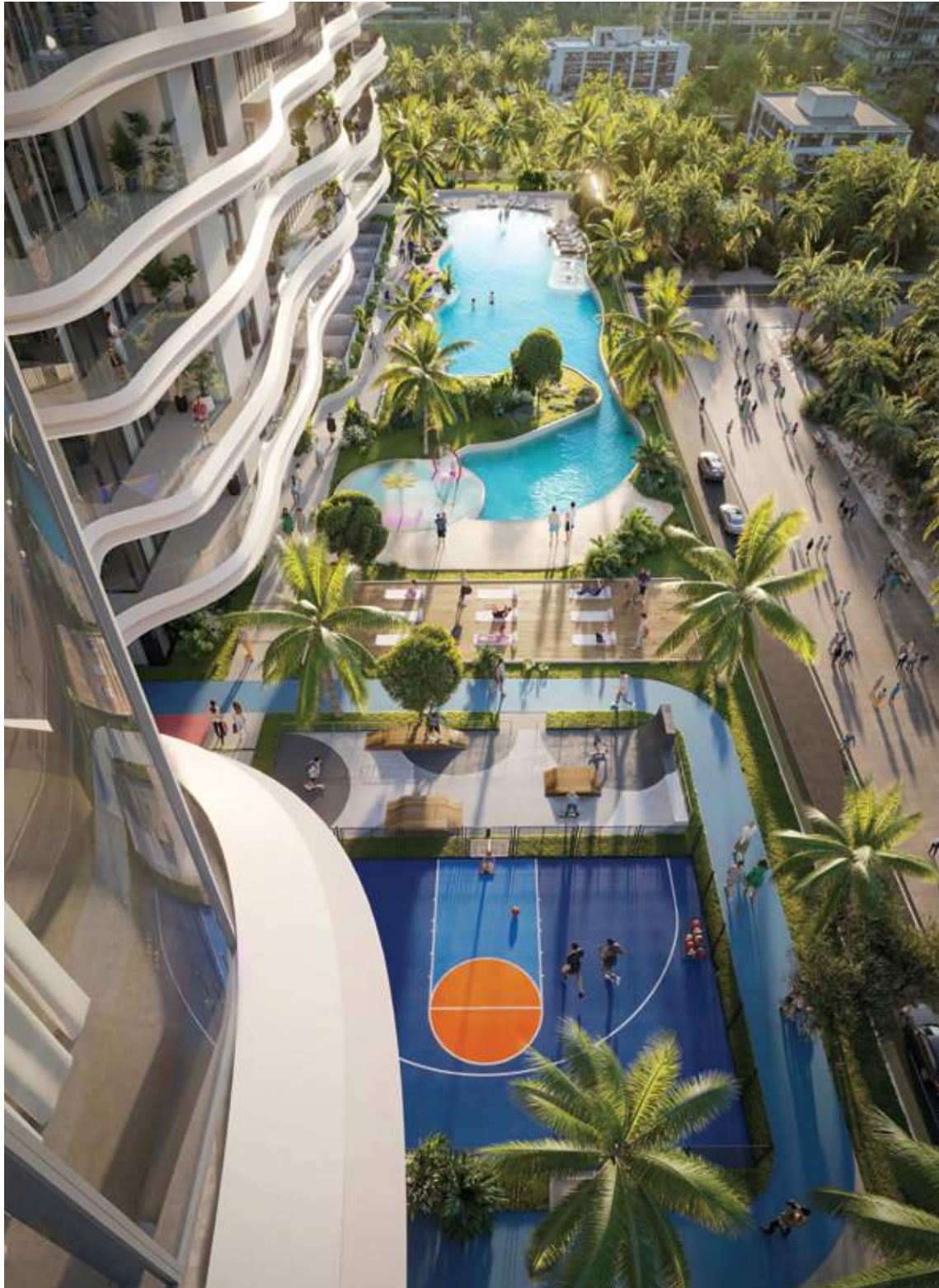

# Community Living, Redefined

One Sky Park offers a curated collection of luxury amenities designed to enrich daily living. At the heart of the experience is the expansive amenity deck, the community's vibrant hub, featuring a 35m sky deck infinity pool, state-of-the-art jungle gym, basketball court, skate park, and exclusive lounge and game zones. Here, residents enjoy a seamless blend of relaxation and socialization, surrounded by lush landscapes and panoramic views, making every moment truly extraordinary.



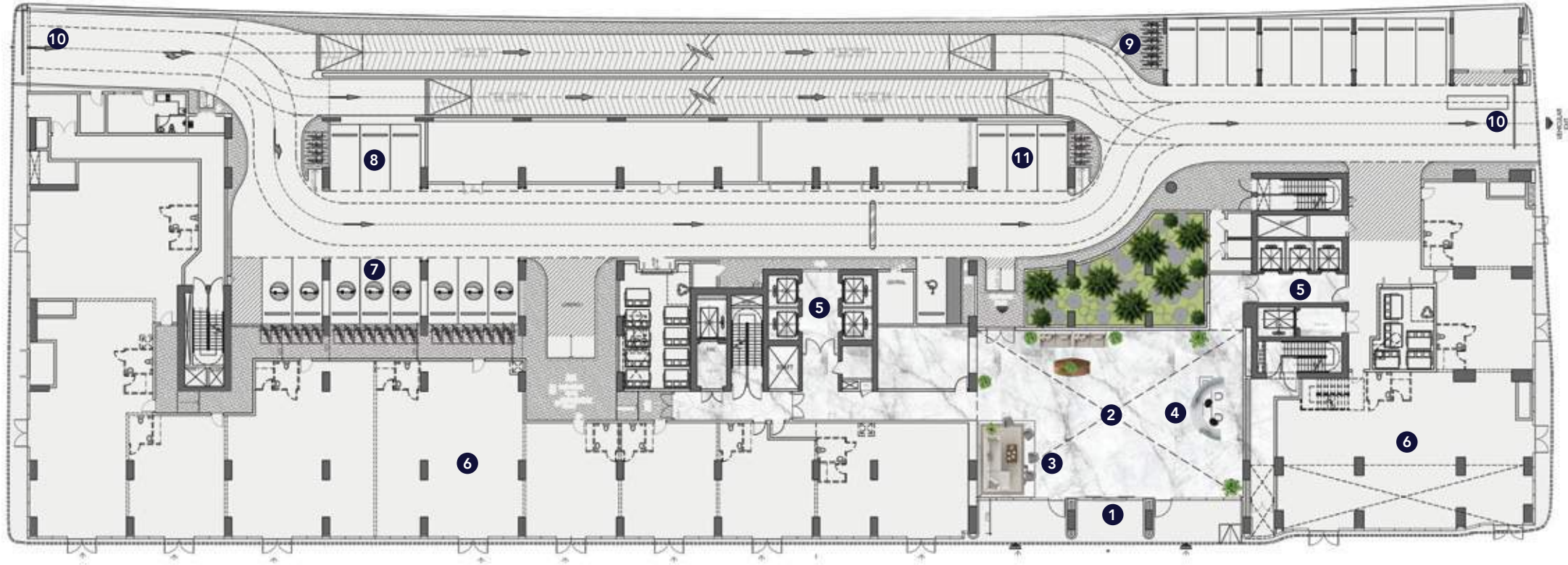

# Ground Floor Amenities

- |                            |                                     |
|----------------------------|-------------------------------------|
| 1. Main Entrance           | 7. Retail Parking                   |
| 2. Double Height Lobby     | 8. EV Charging Station              |
| 3. Lobby Lounge            | 9. Bicycle Parking                  |
| 4. Lobby Reception         | 10. Parking Entrance & Exit         |
| 5. Lift Lobby              | 11. People Of Determination Parking |
| 6. Showroom & Retail Units |                                     |



# Deck Amenities

## Indoor Amenities

- |                          |                            |
|--------------------------|----------------------------|
| 1. Indoor Kids Play Area | 7. Pool Table              |
| 2. Multipurpose Lounge   | 8. Lounge Seating          |
| 3. Library Wall          | 9. Foosball Table          |
| 4. Working Station       | 10. Arcade Zone            |
| 5. Coffee Bar            | 11. Gaming Console Station |
| 6. Games Zone            | 12. Virtual Reality Golf   |
|                          | 13. Air Hockey             |

## Outdoor Amenities

- |                       |                             |
|-----------------------|-----------------------------|
| 14. Beach Edge Pool   | 22. Kids Splash Pad         |
| 15. Sun Loungers Area | 23. Skate Park              |
| 16. Baja Shelf        | 24. Yoga Deck               |
| 17. Leisure Seating   | 25. Padel Tennis Court      |
| 18. Cabanas           | 26. Basketball Court        |
| 19. Hammock Park      | 27. Outdoor Kids Playground |
| 20. Outdoor Shower    | 28. Outdoor/Jungle Gym      |
| 21. Kids Pool         | 29. Jogging Track           |



26<sup>TH</sup> FLOOR (AMENITY FLOOR)

# Rooftop Amenities

## Indoor Amenities

1. Skyfit Gym
2. Male Sauna and Steam Room
3. Male Ice Room
4. Male Changing Room
5. Female Sauna and Steam Room
6. Female Ice Room
7. Female Changing Room

8. Multi Purpose Hall
9. Dining Area
10. Lounge Coffee Bar
11. Lounge Kitchen

## Outdoor Amenities

12. Barbecue Area
13. Rooftop Dining Area
14. Scenic Photo zone
15. Cabanas
16. Leisure Seating
17. Sun Bed
18. Baja Shelf
19. Sky Deck 35m Infinity Pool

20. Yoga Deck
21. Rooftop Jacuzzi
22. Fire Pit lounge
23. Forest Trail
24. Outdoor Cinema
25. Zen Garden
26. Rooftop Grass Zone



The logo for IMAN DEVELOPERS is centered on a dark blue background with flowing, wavy lines in shades of blue and green. The word "IMAN" is written in a large, white, serif font, with a stylized vertical bar on the left side of the 'I' consisting of three horizontal lines. Below "IMAN", the word "DEVELOPERS" is written in a smaller, white, sans-serif font. The background features a repeating geometric pattern of small squares at the top and bottom edges.

IMAN  
DEVELOPERS